

klima2+

EXHIBITION

Marte Elise Nesdal | BAIM3 | KHIO 2021

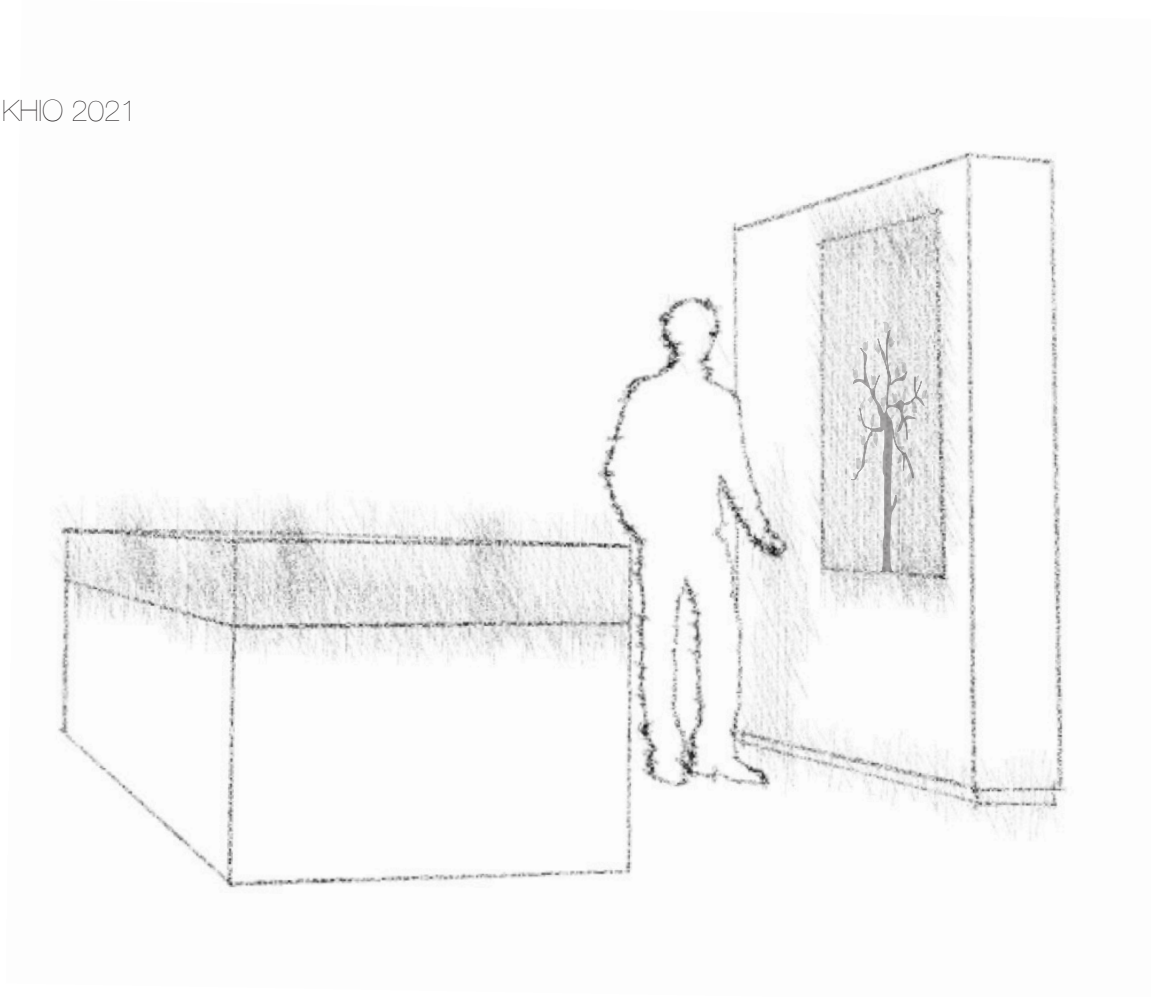

CONCEPT

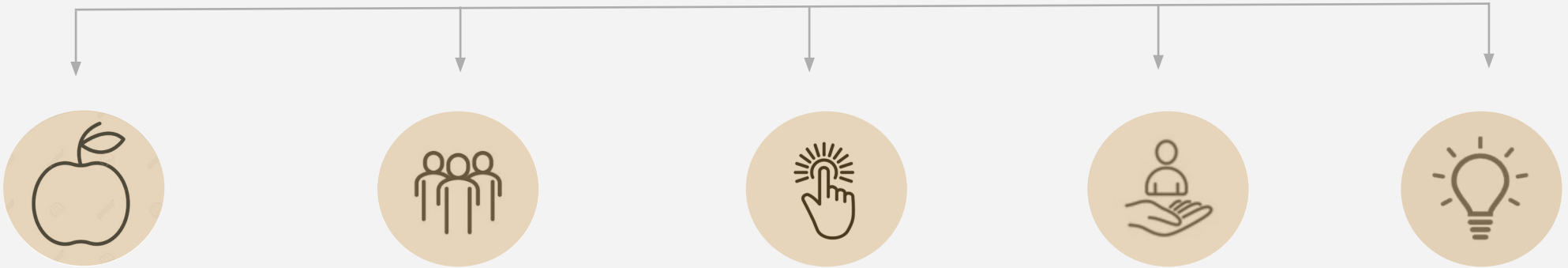

What?

An interactive experience and enlightenment about how the climate impact the future of food and farming and the effects of it.

Whom?

Everyone in any age

Why?

The intension of this is to give the visitors an awaking experience of the future climate damages. Through touching and smelling - the participants is more likely to remember about the message. Food also engage people because it is so important for us.

Role of the visitor

Interact with the object through tasting, reading og touching

Why is it important?

If we can educate about how climate change will impact things that matter to people, then we can act on that knowledge in advance of these things to happen and to think about choices that we do.

Climate Impacts on agriculture and food supply

The impacts of climate change—higher temperatures, extreme weather, drought, increasing levels of carbon dioxide and sea level rise—threaten to decrease the quantity and increase the quality of our food supplies, like coffee, corn, rice, meat, milk and fisheries production.

- ▶ Leaf rust
- ▶ Delayed reproductive development
- ▶ Drowning crops
- ▶ Increased root length
- ▶ Increased soil moisture



As the globe warms up, most of main coffee-growing regions probably won't be suitable for growing this crop anymore, due to heat as well as more frequent rainstorms. Meanwhile, rising temperatures could threaten native coffee trees that grow wild in the forests of Ethiopia and central Africa. The wild trees represent an irreplaceable storehouse of coffee's original genetic diversity. The world's commercial coffee trees are genetically very similar to each other, and those genetically diverse wild trees could be the source of genetic traits that plant breeders may need in order to create commercial trees that can thrive in tomorrow's climate. **e frequent rainstorms.**



The immediate impacts of climate change on rice production systems and food security will be felt in the form of adverse effects of extreme weather events on rice production. Floods also cause indirect damage to rice production by destroying the properties and production means of farmers, and infrastructures supporting rice production such as dams, dikes, roads, etc.



California primary source of almonds for the entire world, is a dramatic illustration of how subtle shifts in climate can have huge effects. California's farms rely heavily on snow that piles up in the Sierra Nevada mountains during the winter, and then slowly melts during the summer, delivering a vital flow of water to the state's irrigation canals. As the climate warms, though, winter precipitation will arrive more often as rain, and the snow that does fall will melt much more quickly, leaving farmers scrambling for water to keep crops alive in late summer.



Wheat, source of bread and a foundation of life in much of the world, will suffer from hotter temperatures — and the country where the impact may be greatest also is among least well-equipped to cope with a shortfall. India is likely to see a large drop in wheat production due to heat stress

Placing

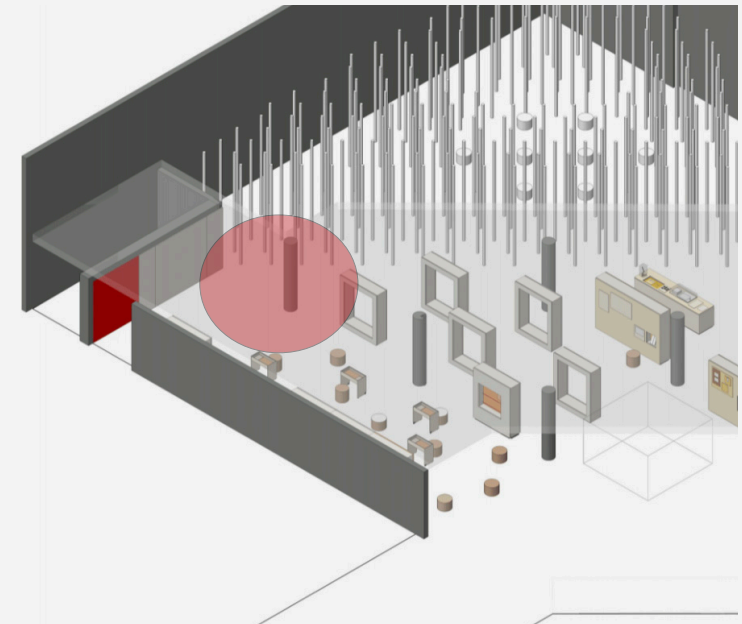
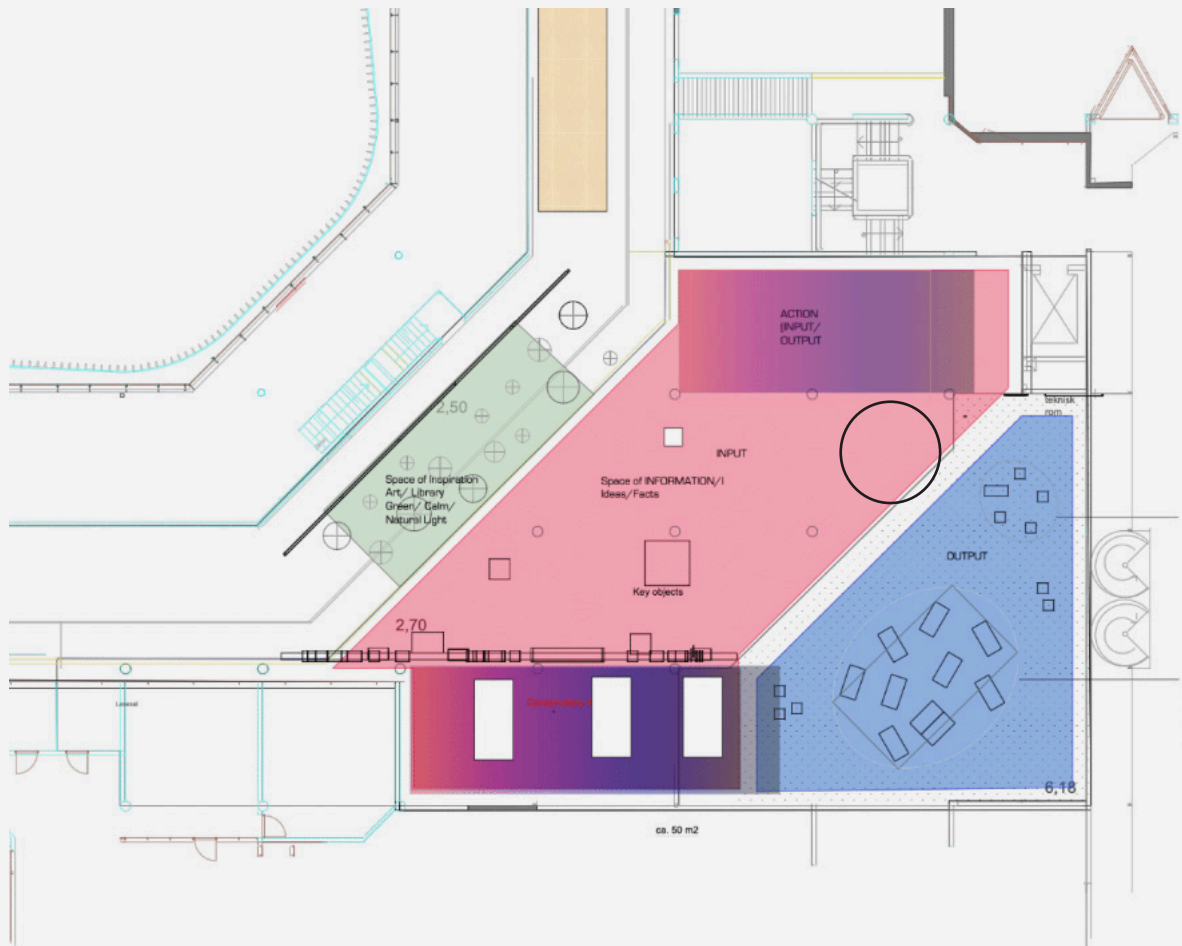

Since my concept is about interaction through senses, this would be a suited place, because it's connected to the output area and between the wood and the workshop.

Sketches / ideas

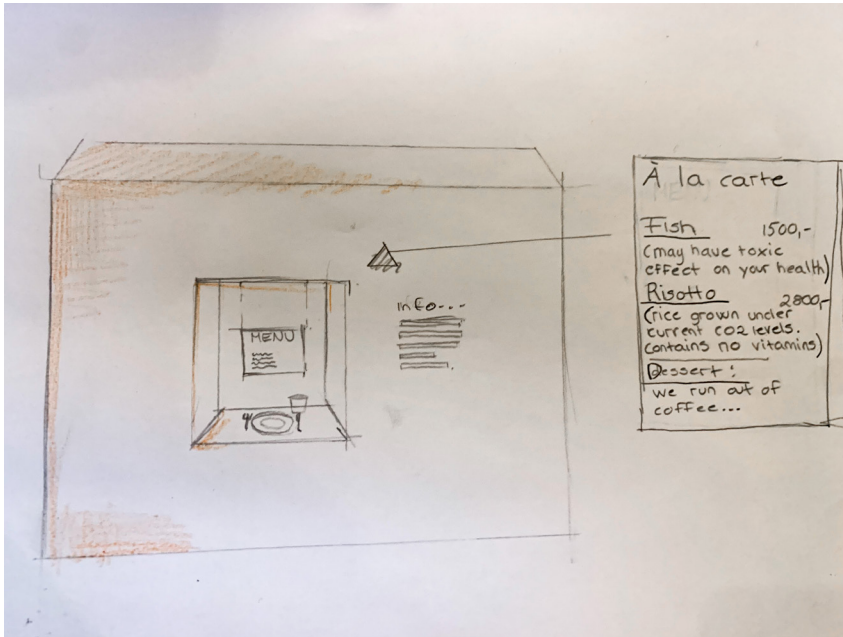

Humoristic?
Tasting of different foods?
Information before or after the tasting?

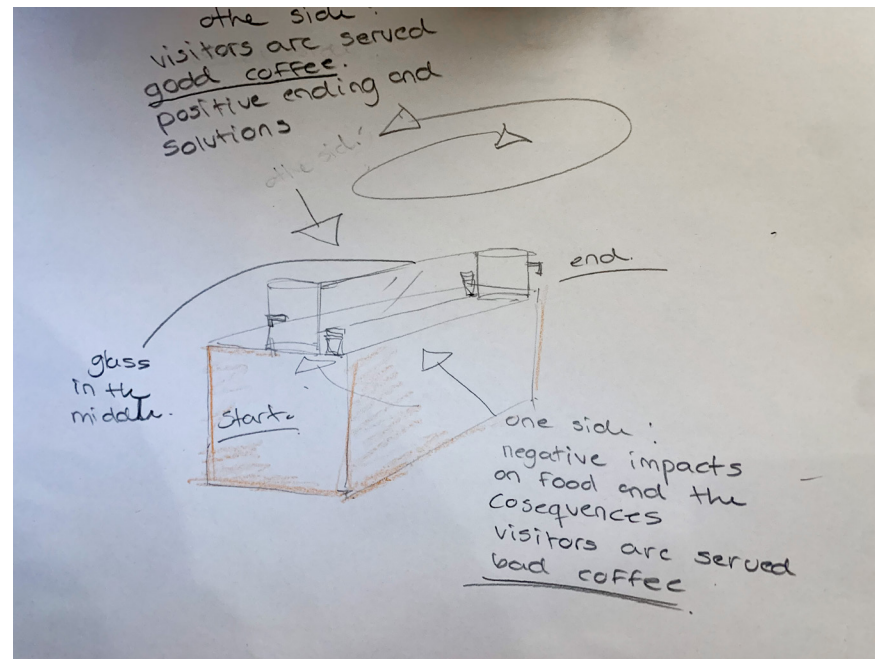
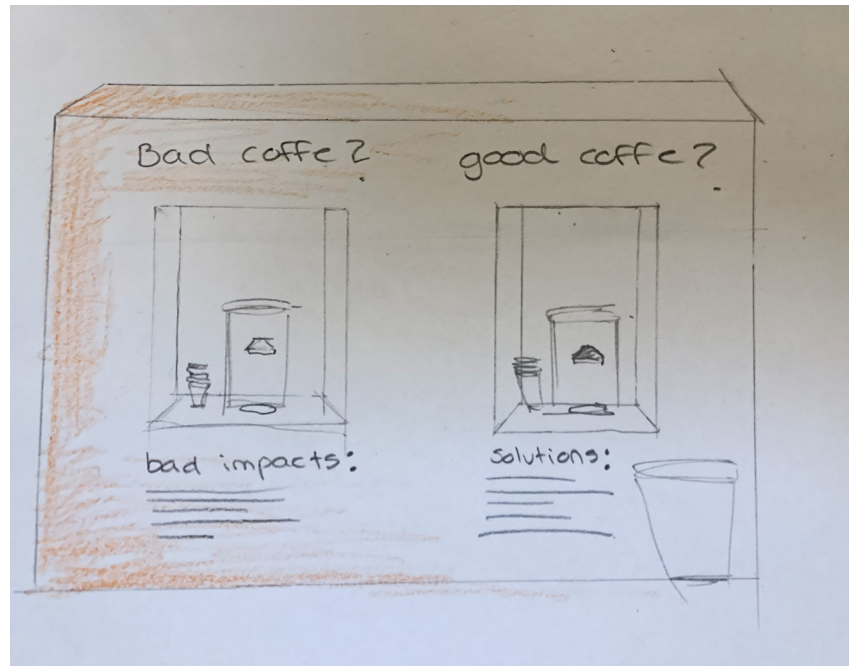

Display/objects

Concept 1

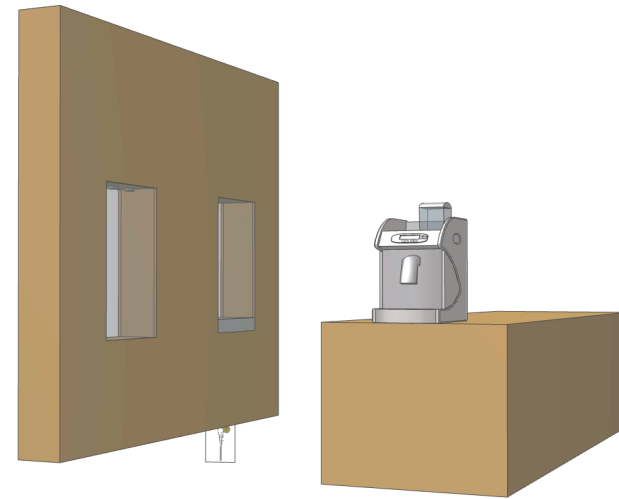

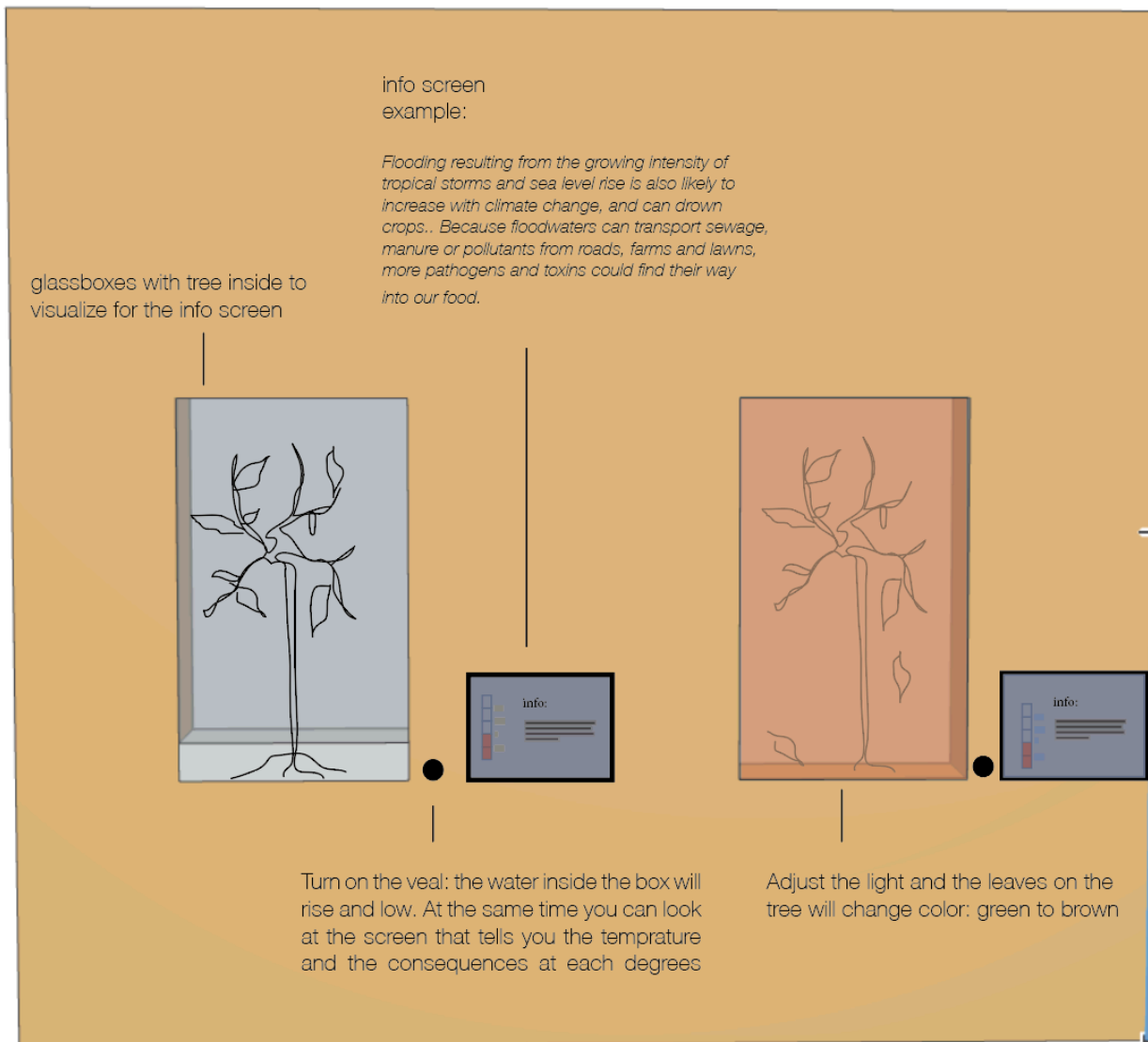

The visitors is served coffee (optional) that taste bad.

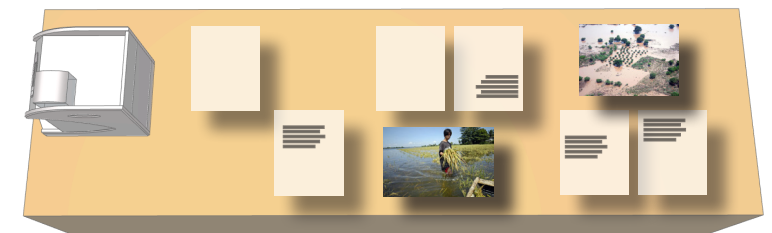

There is a glassbox on the top of the display and on the inside it is displayed different foods, like rice, corn etc (dryfood) that is linked to the different informations on the top.

Display

Concept 2

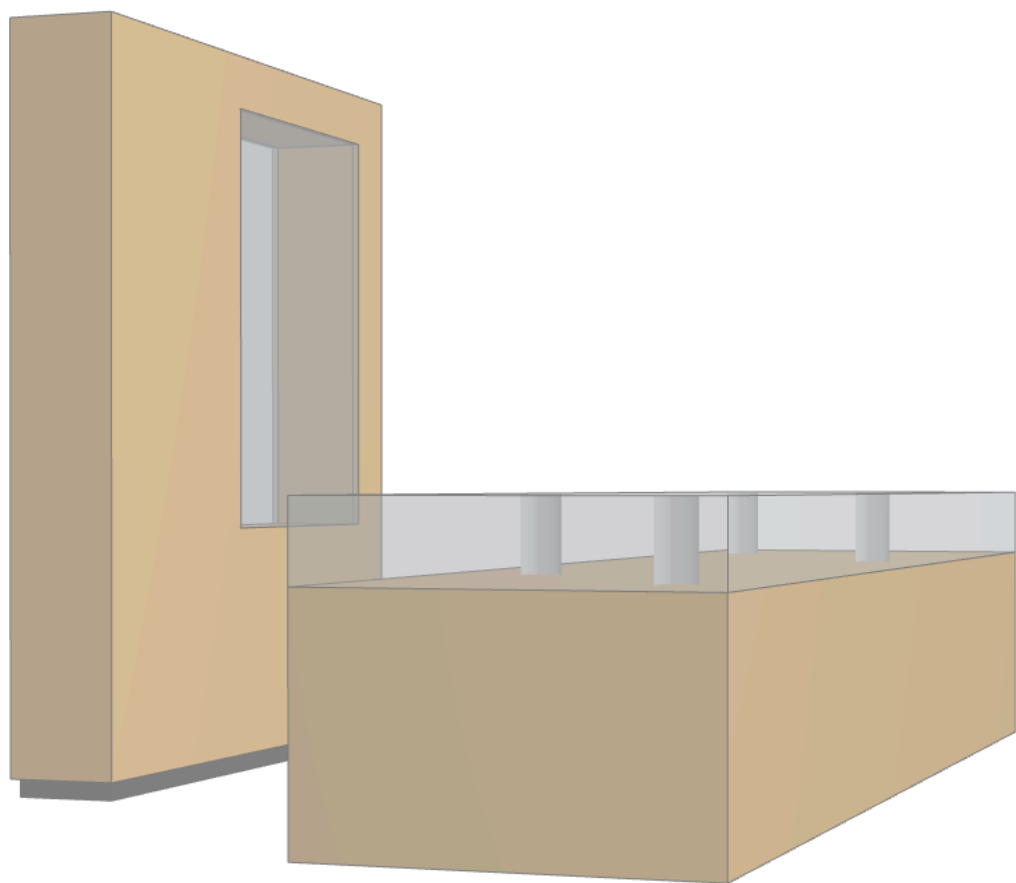

Glassbox

A (fake) tree to visualize for the info screen. The tree is symbolizing what happens to our food plants (the soil, the land) when the climate is changing.

info screen
example:

Flooding resulting from the growing intensity of tropical storms and sea level rise is also likely to increase with climate change, and can drown crops. Because floodwaters can transport sewage, manure or pollutants from roads, farms and lawns, more pathogens and toxins could find their way into our food.

Turn on the wheel: the water inside the box will rise and low. At the same time you can look at the screen that tells you the temperature and how it effects growth, nutrition value etc and the consequences at each degrees.

Agriculture and food supply

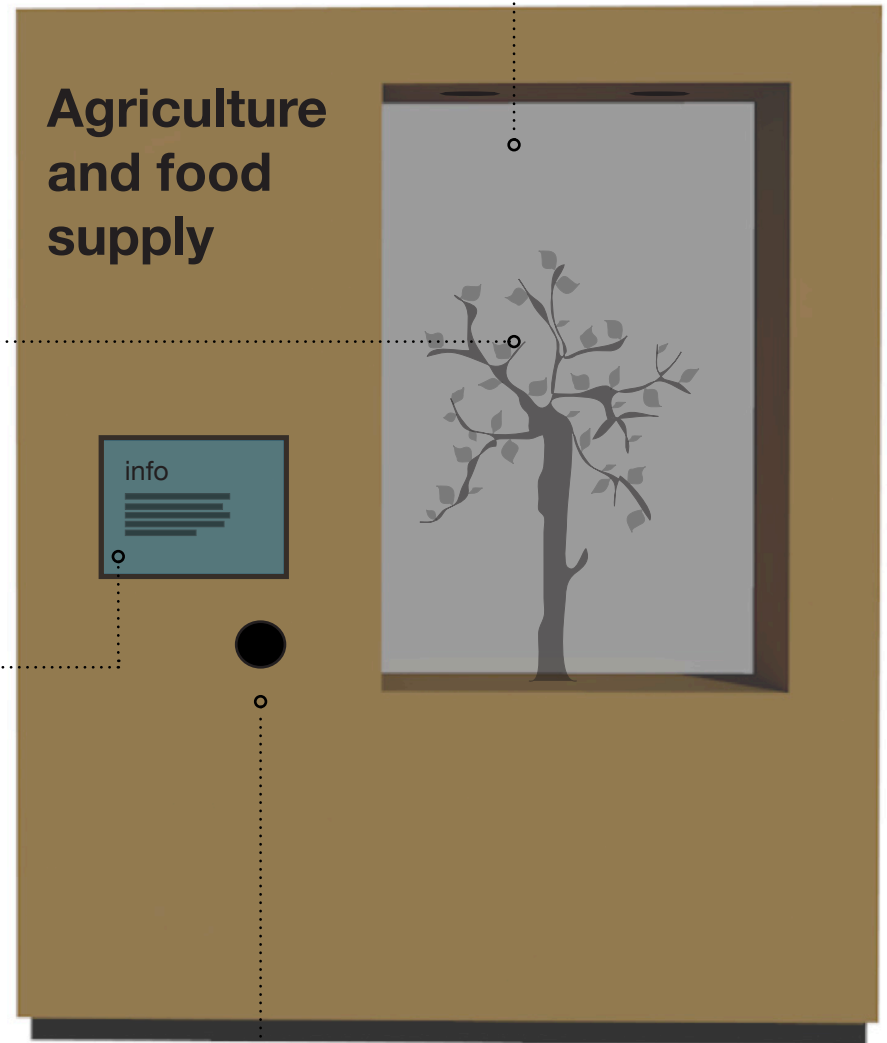
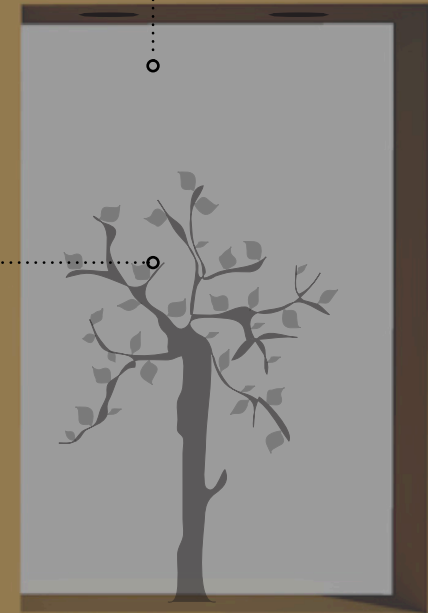

2+

When you turn the wheel up to 2 degrees - what happens is the light will turn red and the water will rise. This is to give the visitors an idea of how the global warming effects the food plants. The intension is to give the visitor the power to control the global warming, and its suppose to be a reflection of our actions. That humans has the power to influence this changes.

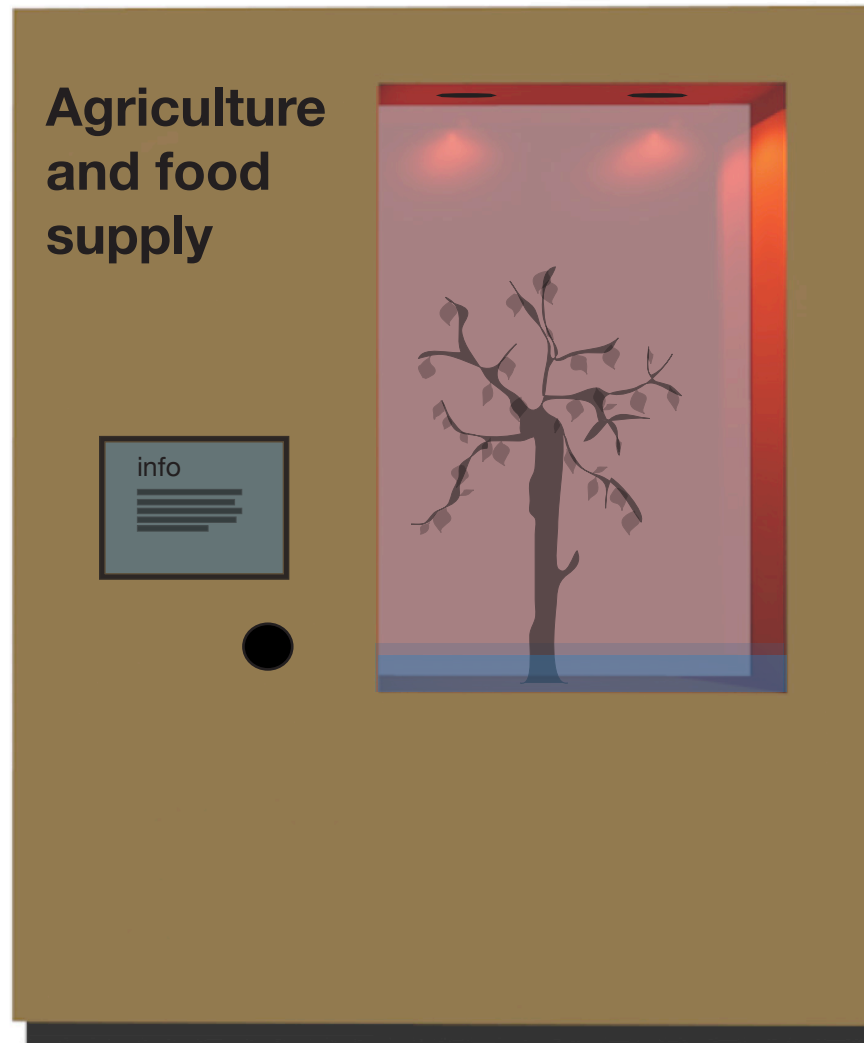

Inside of the glasbox there are different dry foods, like rice, wheat, coffee beans and almonds that is connected to the informations on the top of the table with pictures as well. The intension of this is to allow the visitors to smell the different foods. Its maybe not a very exiting activity, but the intension is to encourage the visitors to use their senses and hopefully this will enlighten the information and motive to read and learn about the different foods.

